

600mm Neutral Cabinets

- Models
- | | |
|---|--|
| <input type="checkbox"/> MV2COF60L - (on legs) | <input type="checkbox"/> MV2COF60C - (on castors) |
| <input type="checkbox"/> MV2COF60LD - (on legs) | <input type="checkbox"/> MV2COF60CD - (on castors) |
| <input type="checkbox"/> MV2CWD60L - (on legs) | <input type="checkbox"/> MV2CWD60C - (on castors) |
| <input type="checkbox"/> MV2CWD60LD - (on legs) | <input type="checkbox"/> MV2CWD60CD - (on castors) |



Standard Features

- Stainless steel construction
- Flat top with low profile rear splashback
- Fascia panel or drawer
- Storage under with adjustable mid shelf with or without door
- 150mm high feet or castors

Options & Accessories

- | | |
|--------------|--|
| • MV2COF60L | (open storage with legs) |
| • MV2COF60C | (open storage with castors) |
| • MV2COF60LD | (open storage with drawer & legs) |
| • MV2COF60CD | (open storage with drawer & castors) |
| • MV2CWD60L | (closed storage with door & legs) |
| • MV2CWD60C | (closed storage with door & castors) |
| • MV2CWD60LD | (closed storage with door, drawer & legs) |
| • MV2CWD60CD | (closed storage with door, drawer & castors) |

Specifications

Moorwood Vulcan 600mm wide neutral cabinets are designed to complement the Moorwood Vulcan Ultimate line of prime cooking equipment, providing essential work space and storage whilst keeping the same uniform profile throughout the cookline.

These units are available with a drawer and/or a door to enclose storage under.

Moorwood Vulcan offers the ultimate in design and service excellence with this stylish, functional selection of medium duty prime cooking equipment, manufactured to the highest standards.

The product is ideal for a hard working kitchen and is designed to provide many years of value-for-money service.

These units suite with other Moorwood Vulcan Ultimate products to make a modular cooking centre.



ENODIS UK FOOD SERVICE

5E Langley Business Park, Station Road, Langley, Berkshire SL3 8DS
Fax: 01753 485901 Email: info@enodis.com

Group Tel: 0845 370 4888

www.enodisuk.com

Datasheet Part No. 933344-01

Revision No. 1

Nov 2008



MV2COF60L
MV2COF60C with castors

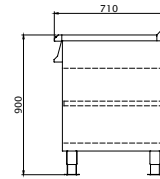
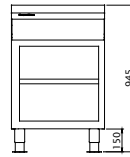

MV2COF60LD
MV2COF60CD with castors

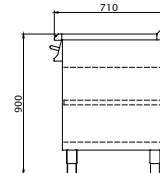
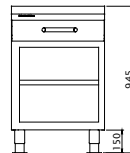

MV2CWD60L
MV2CWD60C with castors

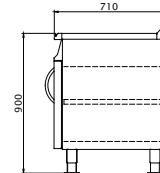
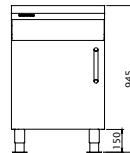
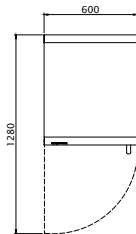

MV2CWD60LD
MV2CWD60CD with castors

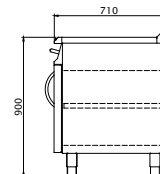
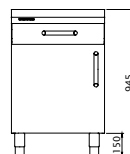
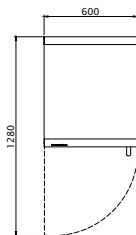

DIMENSIONS

MODEL NO.	OVERALL SIZE			NET WEIGHT	SHIPPING WEIGHT (APPROX)
	HEIGHT	WIDTH	DEPTH		
MV2COF60L (open storage with legs)	945mm	600mm	710mm	36kg	40.6kg
MV2COF60C (open storage with castors)	945mm	600mm	710mm	36kg	40.6kg
MV2COF60LD (open storage with drawer & legs)	945mm	600mm	710mm	44kg	48.6kg
MV2COF60CD (open storage with drawer & castors)	945mm	600mm	710mm	44kg	48.6kg
MV2CWD60L (closed storage with door & legs)	945mm	600mm	710mm	44kg	48.6kg
MV2CWD60C (closed storage with door & castors)	945mm	600mm	710mm	44kg	48.6kg
MV2CWD60LD (closed storage with door, drawer & legs)	945mm	600mm	710mm	52kg	56.6kg
MV2CWD60CD (closed storage with door, drawer & castors)	945mm	600mm	710mm	52kg	56.6kg

For further information on MV products and services or advice on which unit suits you best please contact the sales department.

ENODIS UK FOOD SERVICE

5E Langley Business Park, Station Road, Langley, Berkshire SL3 8DS
Fax: 01753 485901 Email: info@enodis.com

Group Tel: 0845 370 4888

www.enodisuk.com

Datasheet Part No. 933344-01

Revision No. 1

Nov 2008